

Date: 5th December 2020

The vertical truss shown below is supported by a pin at A and a roller at B. Compute the forces in member EC, CF and DF and indicate whether the members are in tension (T) or compression (C).

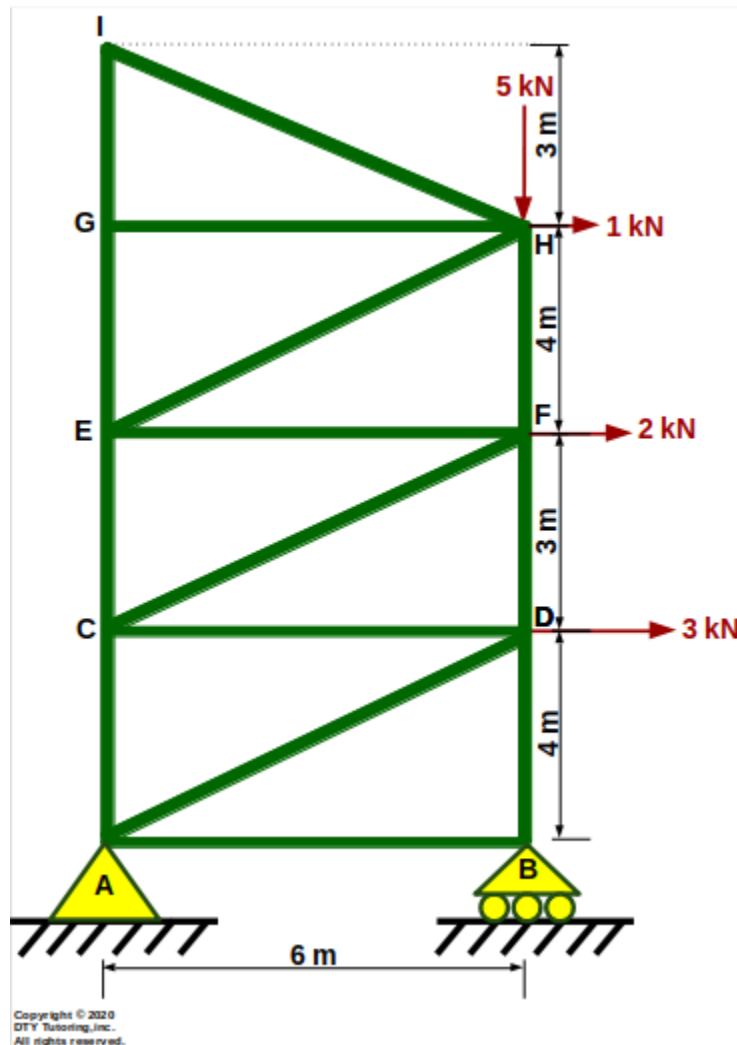



DTY Tutoring, inc.
Email: dtytutoring@gmail.com
Website: www.dtytutoring.com

Answers (refer to solutions for detail)

$$F_{EC} = 0.67 \text{ kN (T)}$$

$$F_{CF} = 3.606 \text{ kN (T)}$$

$$F_{DF} = 7.7 \text{ kN (C)}$$